

IMPORTANT! SAFETY INSTRUCTIONS:



READ THIS MANUAL BEFORE USING THIS APPLIANCE.



**WARNING! READ ALL SAFETY WARNINGS AND INSTRUCTIONS
FAILURE TO FOLLOW THE WARNINGS AND INSTRUCTIONS LISTED
BELOW MAY RESULT IN ELECTRIC SHOCK, FIRE AND/OR INJURY**

- **The intended use of this appliance is explained in this manual. The use of accessories other than those recommended in this manual may present a risk of personal injury.**
- **Always check the mains voltage corresponds to the voltage on the rating plate.**
- Please read these operating instructions through carefully before using the pan.
- Only connect the unit to an AC power supply. The voltage listed on the rating plate must coincide with the voltage of your power supply.
- Never leave the unit unattended during use.
- Keep children away from the unit. Pay particular attention when children are in the vicinity!
- Avoid danger of tripping, do not allow the electric cable to hang down.
- Keep the electric cable away from hot surfaces and open flames or sharp edges.
- Never touch the electric cable and plug with wet hands.
- Never immerse the unit, electric cable or plug into water or other liquids. Danger to life through electric shock!
- Do not use the unit outside.
- The unit is only intended for use in the house and not for commercial purposes.
- Check the unit, electric cable and plug regularly for visible damage. Do not use the unit under any circumstances if you have noted any damage.
- Have damage repaired by a qualified specialist only. Never attempt to repair any damages yourself.

- Only use the unit on a heat-resistance surface. Never position the unit close to hot surfaces or open flames.
- High temperatures are present during operation. Only touch the handles on the unit.
- Connector must be removed before the appliance is cleaned and that the appliance inlet must be dried before the appliance is used again.
- Only the appropriate connector must be used.
- The appliance is not intended to be operated by means of an external timer or a separate remote-control system
- Children should be supervised to ensure that they do not play with the appliance.
- Do not operate the appliance with a damaged cord or plug. If the supply cord of appliance is damaged, it should be replaced by a suitably qualified person, or disposed of responsibly.
- This appliance can be used by children aged from 8 years and above and persons with reduced physical, sensory or mental capabilities or lack of experience and knowledge if they have been given supervision or instruction concerning use of the appliance in a safe way and understand the hazards involved. Children shall not play with the appliance. Cleaning and user maintenance. shall not be made by children.
- Cooking appliances should be positioned in a stable situation with the handles (if any) positioned to avoid spillage of hot liquids.

PACKAGING INFORMATION:

The unit is packaged to protect against transport damage. The packaging materials are recyclable. Please dispose of the packaging materials via the appropriate recycling system in an environmentally-friendly manner.

1. Glass cover handle
2. Power connection base
3. Basic unit
4. Handles (include heat shield)
5. Cooking surface
6. Glass cover

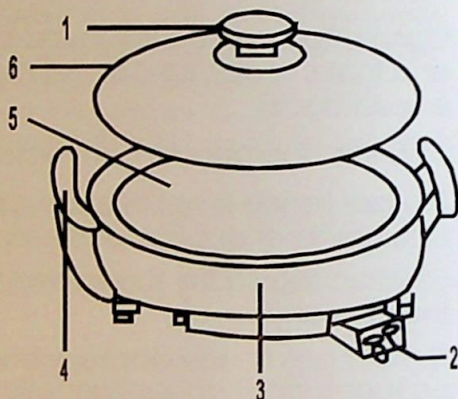

TEMPERATURE SENSOR:

1. Temperature sensor
2. Electric plug
3. Electric cable
4. Temperature regulator
5. Control lamp

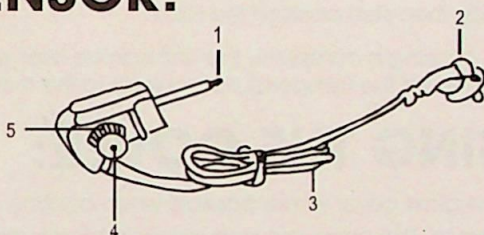

START-UP:

NOTE:

Before using the unit, clean the unit and cover carefully. Do not use any aggressive detergents, brushes with metal or nylon bristles or sharp objects such as knives or spatulas for cleaning the unit. Avoid damaging the non-stick coating. Always dry the unit thoroughly after cleaning it.

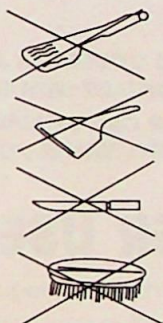
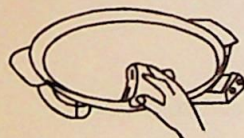

CONNECTING THE UNIT:

1. Connect the temperature regulator to the base of the basic unit. Make sure that the plug is connected properly.
2. Set the temperature selector switch to heat level "0".
3. Connect the plug to a 220-240V AC 50Hz fused socket outlet.

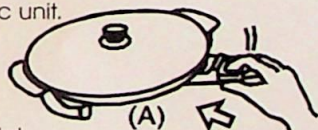

ATTENTION:

DO NOT USE A MULTIPLE OUTLET STRIP OR EXTENSION CABLE.

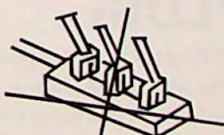

PREPARING FOODS:

1. Brush the pan with a little cooking oil at first.
2. Set the temperature regulator to the required heat level. The control lamp will light up to signal that the unit is ready for use (ON).



It takes about 5-10 minutes after the unit is switched on before the control lamp goes off. You can then start cooking the food.

Once cooking is complete, the unit can be kept warm. To do this, set the temperature regulator to the thermostat level.

USING THE COVER:

Use the glass cover where possible when cooking all food types. The cover prevents smells from escaping and reduces cooking time.



NOTE:

THE GLASS COVER HAS A VENT THROUGH WHICH HOT STEAM CAN ESCAPE!

AVOID CONTACT WITH THIS ESCAPING STEAM.

THE COVER CAN BECOME EXTREMELY HOT DURING OPERATION THEREFORE USE OVEN GLOVES, ETC. WHERE POSSIBLE WHEN REMOVING THE COVER TO AVOID BURNS.

AFTER USE:

Set the temperature regulator to the 0 level and pull the plug out of the mains socket! Allow the unit to cool down thoroughly before cleaning it.

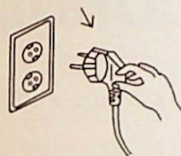

PLUG:

1. This appliance has been fitted with a BS UK compliant plug which should not be replaced or removed.
2. The plug is fitted with a UK compliant fuse link which is suitable for this type of appliance and should only be replaced by a fuse link of the same rating.
3. If access to the fuse link is only possible by removing the plug cover this must only be done by a suitably qualified person.
4. If the plug or the mains cable of this appliance is damaged do not use and dispose of the appliance responsibly.
5. This appliance is earthed.



Information on Waste Disposal for Consumers of Electrical & Electronic Equipment



This symbol indicates that this product should not be treated as normal household waste and it should be recycled. Please take it to your nearest collection facility or for further details contact your local council or visit www.recycle-more.co.uk.

Imported by Benross®



MADE IN P.R.C